

Windows Hello for Business

Windows Hello is the latest step in our continuous effort to improve our security posture.

Windows Hello will simplify your sign-in process by eliminating the need for you to type in your complex passphrase while making your system more secure. Instead, you can sign onto your Windows laptop or desktop by using a 6-digit PIN, facial recognition, or fingerprint.

Getting Started

1. To get started, restart your computer, and sign in with your passphrase. Your computer will then walk you through the steps needed to setup Hello starting with creating a PIN.

Note: If you do not see a prompt like the one pictured below, be patient, your machine must be online for a while and may need a restart to get this new security feature.

****Your PIN or biometric scans will only work on your device****

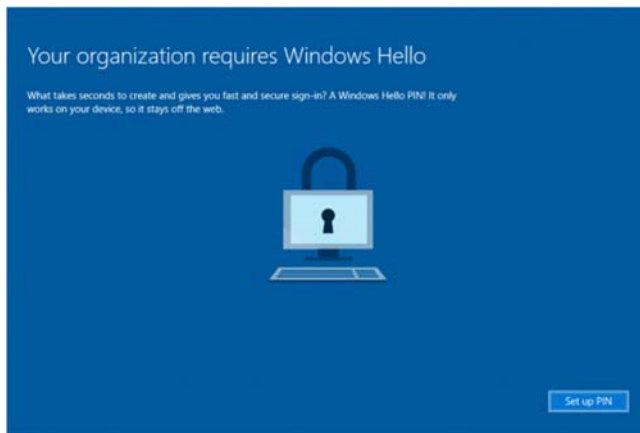

Setting up Hello Facial Recognition

1. After setting up your PIN, you can log back into your computer.
2. Click on your **Start** button.
3. Click on **Settings**.

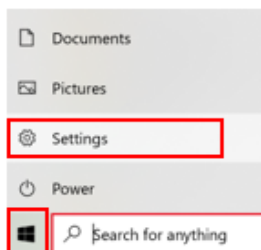

4. Click on **Accounts**.

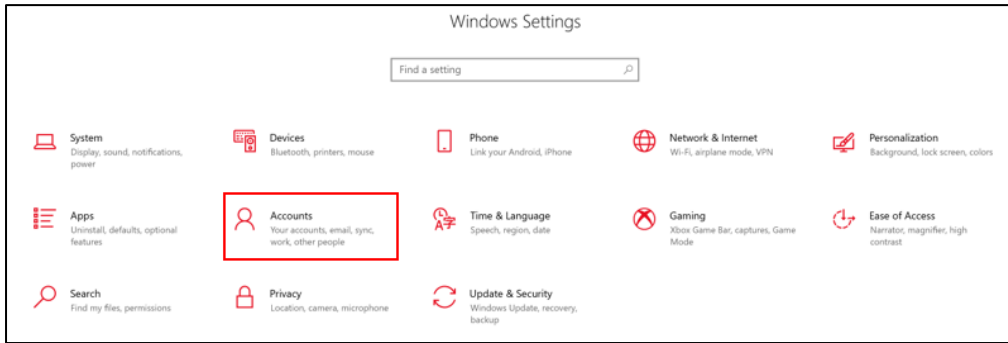

5. Click on **Sign-in options**.

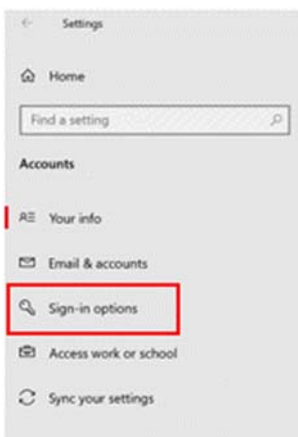

6. Click **Windows Hello Face**, then **Get started**. *Note: Make sure your front facing camera is on.*

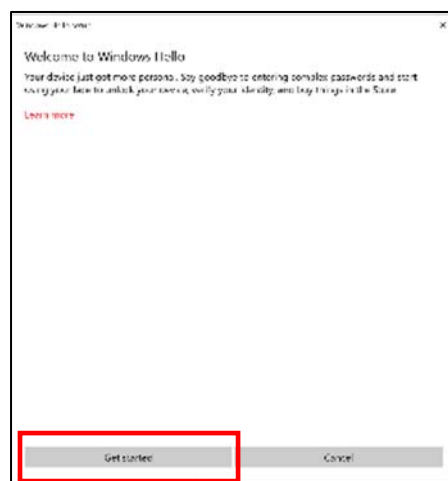

7. Enter the PIN you created and click **Ok**.



8. Keep looking at the camera and let the setup do its thing.

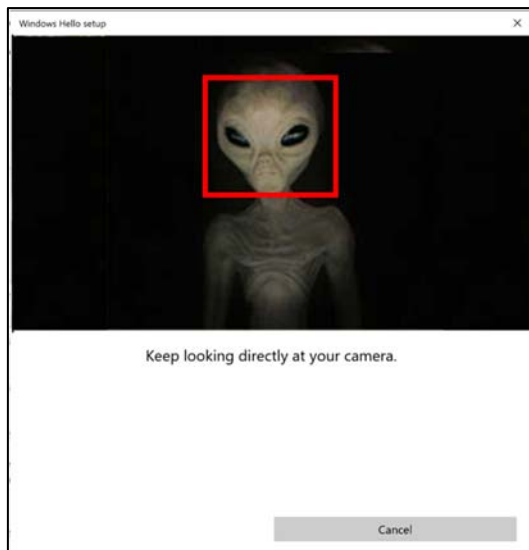

9. You are all set!

